

UNIT 5

3rd Floor

10,946 sq ft / 1,016.9 sq m

TORRINGTON PLACE

ALFRED MEWS

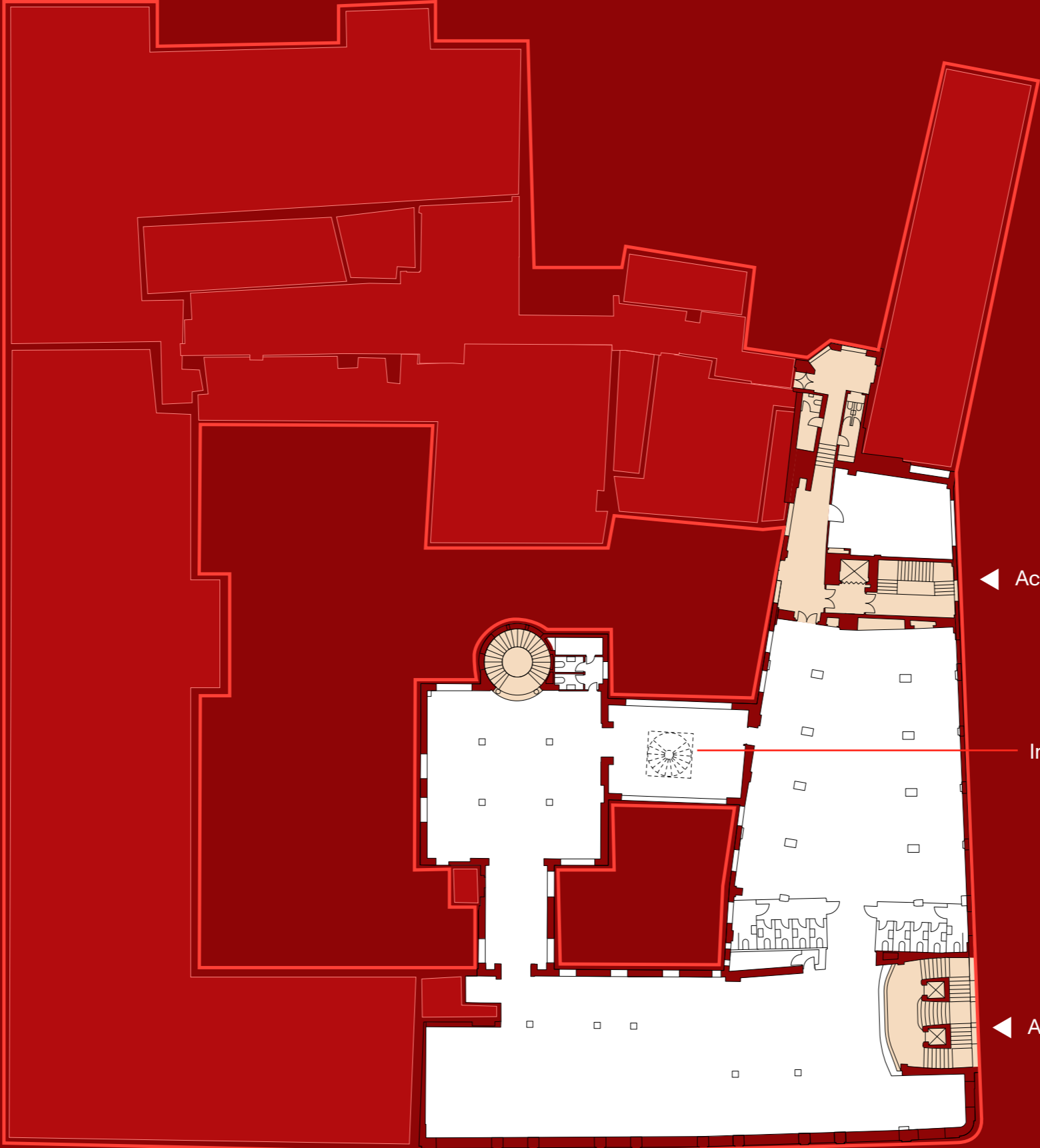

Access from Reception 1

Indicative Staircase

Access from Reception 3



NORTH

TOTTENHAM COURT ROAD

0.0 4.0m 8.0m 12.0m 16.0m 20.0m



Graphical Scale 1:200